

Millbank Close

BRISLINGTON

APPROXIMATE FLOOR AREA
75 SQM / 807 SQFT

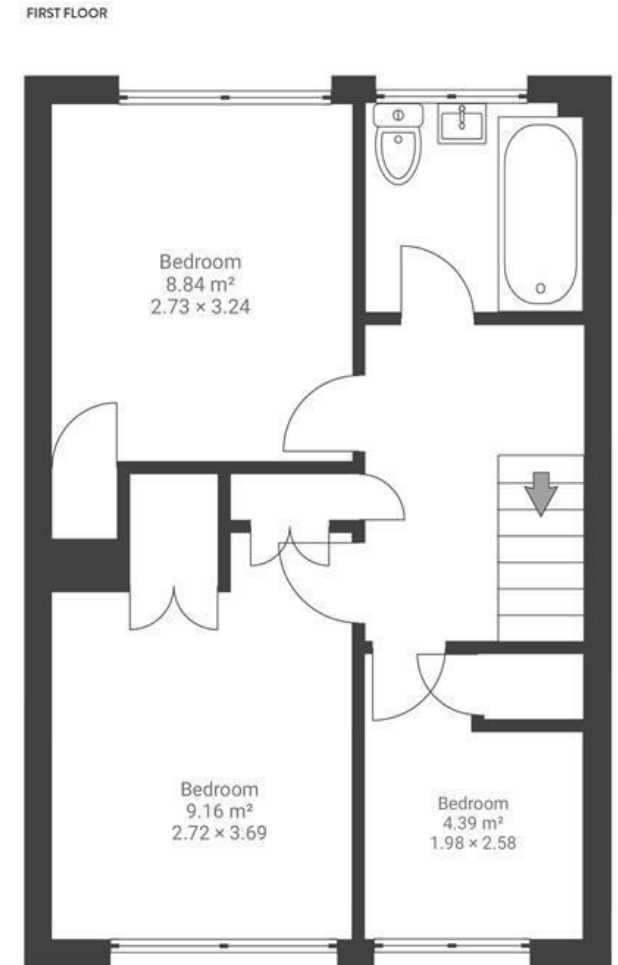
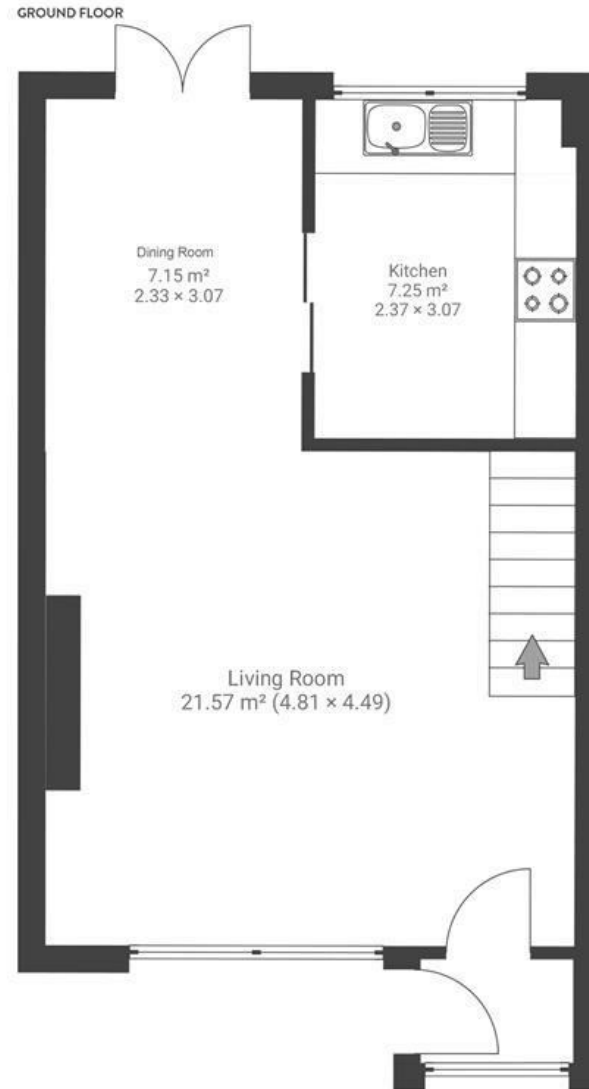

Boardwalk

Millbank Close

BRISLINGTON, BRISTOL

£

£325,000



BS4 4PY

zZz

3 Bedrooms



1 Bathrooms

"For us this house is all about the light. Those huge windows that make every room feel bright and inviting. It also means you can see who's coming to the front door and wave them in. The cul-de-sac means its quiet and peaceful here, and having Nightingale Valley on your doorstep is perfect for a stroll. The kitchen is a work of love. We moved the door so that you can chat while hosting and the orange makes it cosy but fun, colour is key in this house! Also keep an eye out for the spring bulbs."

